

Level 00

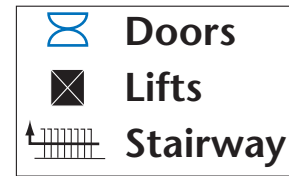

- A Staff / Service Lift
- B Clinical Lifts
- C Public Lifts

- 1 Accident & Emergency Dept.
- 2 Radiology (A&E)
- 3 Plastics & Burns / Out Patient Dept.
- 4 Health Records (P&B)
- 5 Prosthetics
- 6 Office Suite
- 7 Laser Suite
- 8 Medical Photography
- 9 Physiotherapy
 - Dietetics
 - Occupational Therapy
 - Speech & Language Therapy

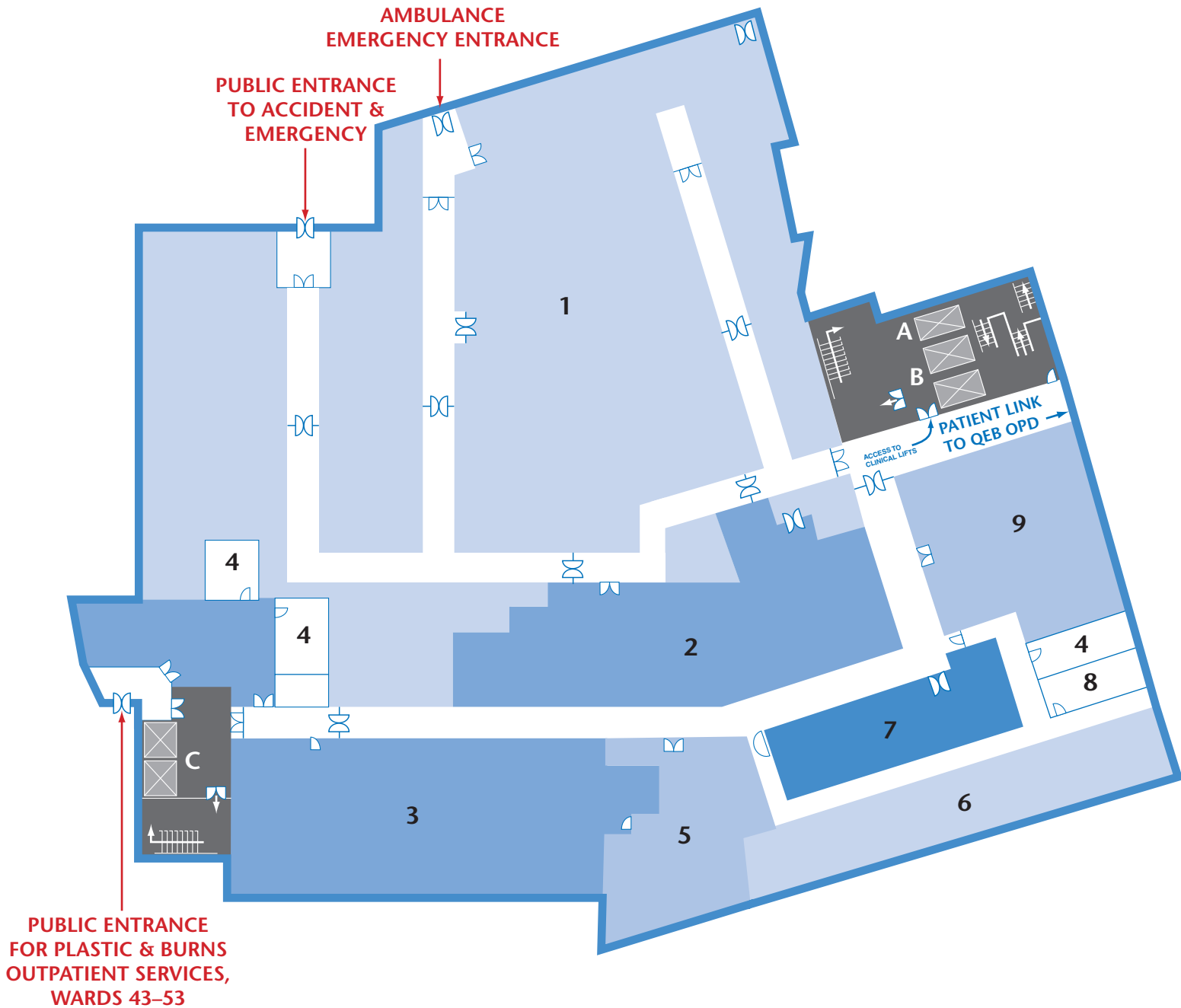

Level 1

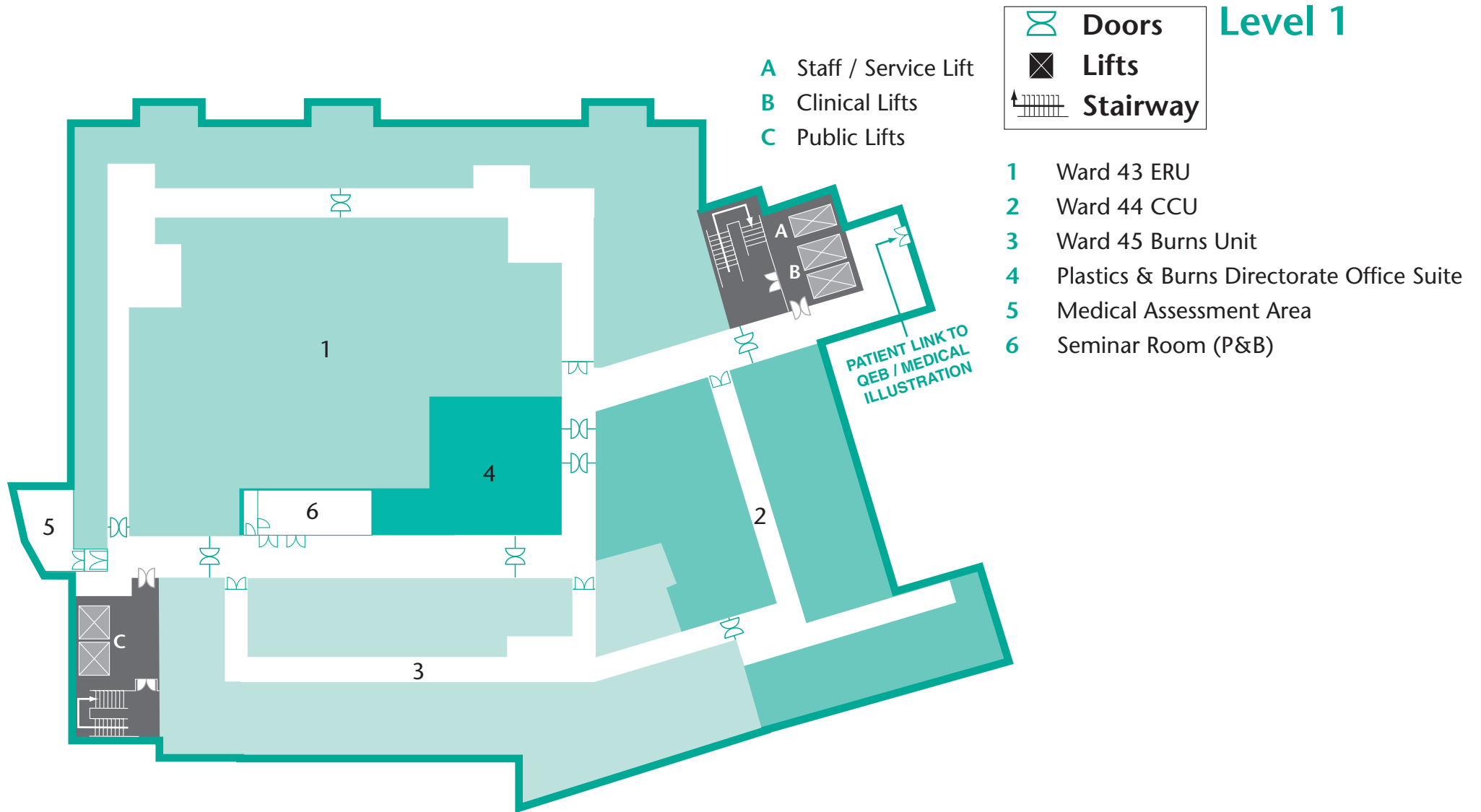

Level 01

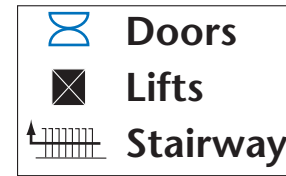

- A Staff / Service Lift
- B Clinical Lifts

- 1 Theatres U-Z (P&B)
- 2 Staff Changing Accomodation and Canteen Facilities

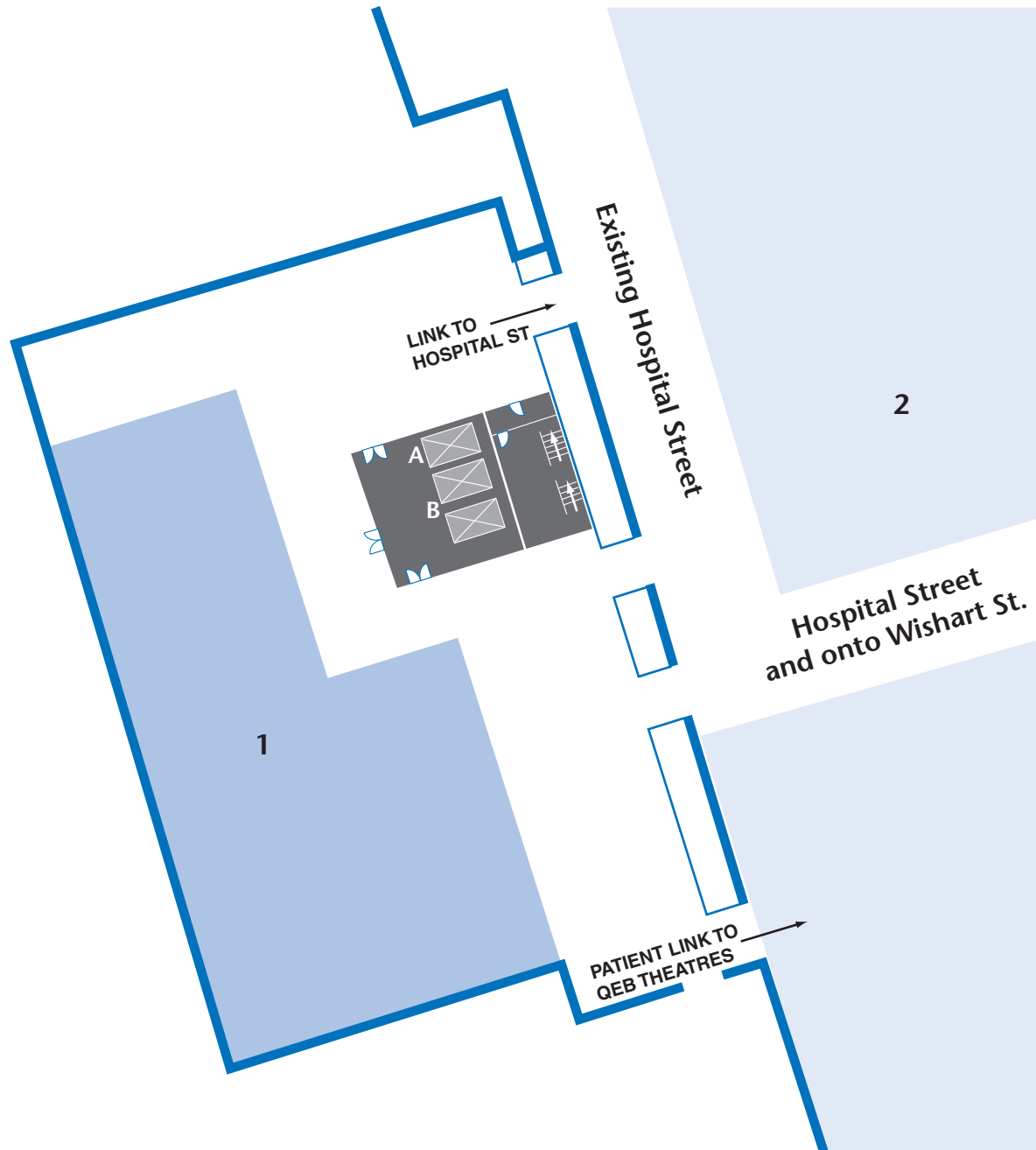

Level 2





- A Staff / Service Lift
- B Clinical Lifts
- C Public Lifts

Plastic Surgery Wards

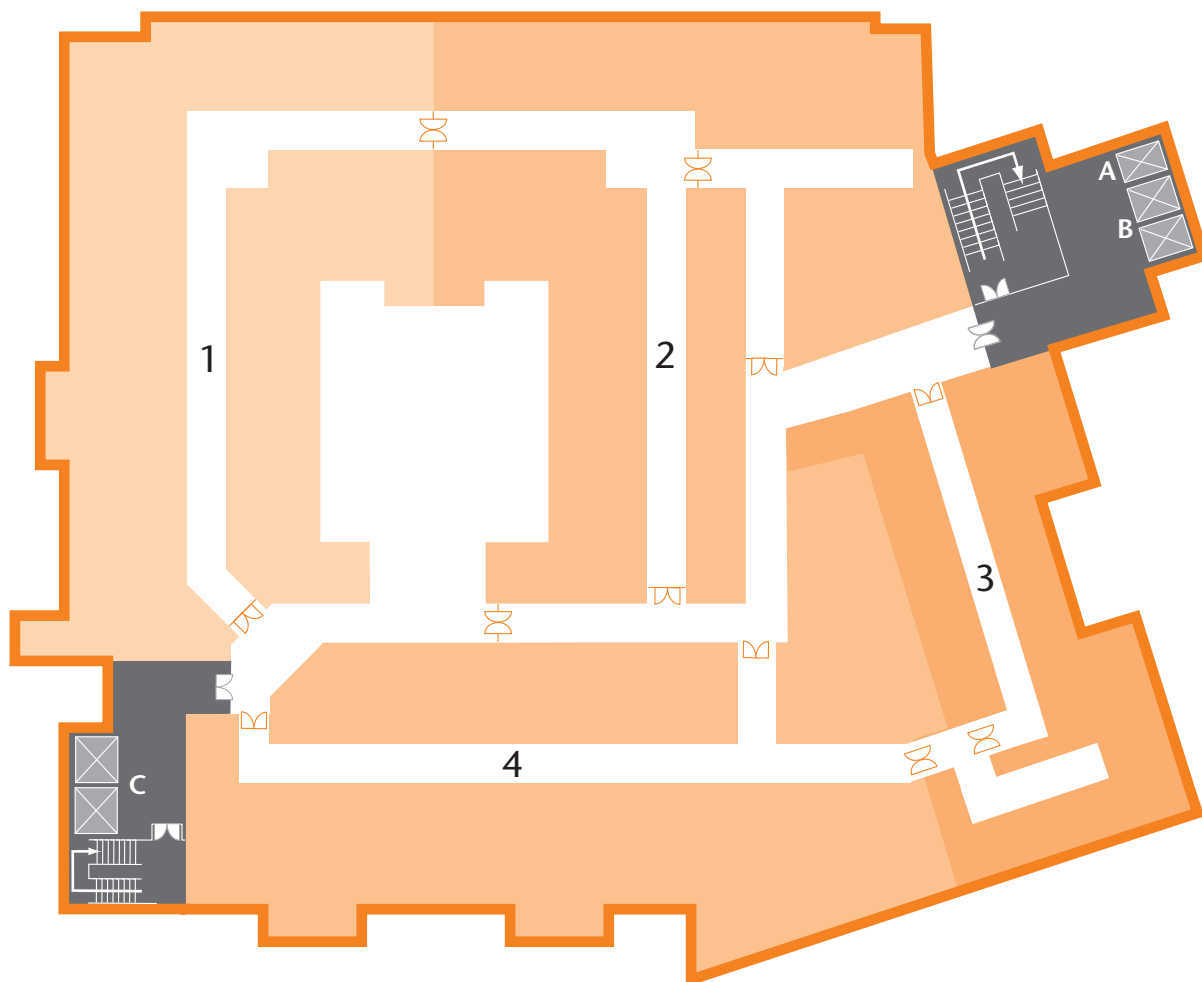
- 1 Ward 46
- 2 Ward 47
- 3 Ward 48
- 4 Ward 49



Level 3

 **Doors**
 **Lifts**
 **Stairway**

- A** Staff / Service Lift
- B** Clinical Lifts
- C** Public Lifts

- Orthopaedics**
- 1** Ward 50
 - 2** Ward 51
 - 3** Ward 52
 - 4** Ward 53

